



2.0 Channel Sound Bar with Dolby Audio

3100 Series

User Manual



# Contents

---

<b>1 Before you begin .....</b>	<b>3</b>
<hr/>	
<b>2 Welcome .....</b>	<b>4</b>
What's in the box .....	4
Overview of the Sound Bar .....	6
Position Your Sound Bar .....	8
Install/replace the remote control batteries .....	8
Overview of the Remote Control .....	10
<hr/>	
<b>3 Connect your Sound Bar system .....</b>	<b>12</b>
Connect with the optical cable .....	13
Direction for setting up your Sound Bar using an optical cable .....	14
Connect with the 3.5mm-to-3.5mm audio cable .....	15
Connect the Sound Bar with your Bluetooth device ....	16
Use the USB cable or device for music playback.....	17
Connect your Sound Bar to power supply .....	19
<hr/>	
<b>4 Use your Sound Bar system.....</b>	<b>20</b>
Use your Sound Bar with the side panel or remote control .....	20

---

<b>5</b>	<b>Specifications .....</b>	<b>22</b>
----------	-----------------------------	-----------

---

<b>6</b>	<b>Notice .....</b>	<b>23</b>
	Declaration of conformity .....	23
	Disposal of your old product and battery .....	23
	Trademarks .....	25

---

<b>7</b>	<b>FAQ .....</b>	<b>26</b>
----------	------------------	-----------

# 1 Before you begin

- Carefully read and observe all safety instructions in the safety leaflet.
- This soundbar is intended for indoor use only. In case it accidentally gets in contact with small amounts of water, unplug immediately and use a dry cloth to remove the water.
- Unplug the soundbar if it is not used for long periods of time or during lightning storms.
- Make sure the soundbar is installed on a solid surface for the best experience.
- Only use AAA 1.5V non-rechargeable batteries for the remote control.
- In case any of the cables are visibly damaged or pinched, unplug the soundbar and replace the cable.
- Be careful not to sharply bend the optical cable as they may affect the performance.
- Protect your hearing by adjusting to a proper volume.



## 2 Welcome

Congratulations on the purchase of your new TCL Sound Bar! After it is set up and connected, you can experience a superb sound quality and state-of-the-art design to best fit your home entertainment system. You are recommended to read through this user manual which helps you set up, connect and operate the product easily and properly.

Let's get started.

---

### What's in the box

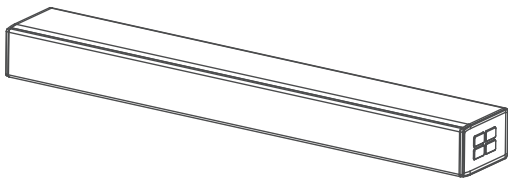

Sound Bar

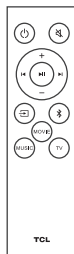

Remote control



AAA battery x 2



AC power cord



Quick Start Guide

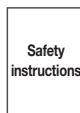

Safety leaflet

# Overview of the Sound Bar

## Front Side



**Power button:**  
Short press to power on/off  
Press and hold to reset to  
factory default.

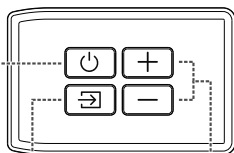



**Source button:**  
Press to switch the audio source  
among AUX/BT/OPT/USB modes.

**Volume buttons:**  
Press to increase or  
decrease the volume level.

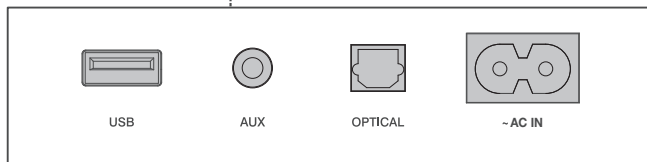
## Back Side



- 1   
Press to power on/off.  
Press and hold to reset to factory default.
- 2   
Press to switch the audio source among  
AUX/BT/OPT/USB modes.
- 3   
Press to increase or decrease the volume level.
- 4 **USB Type A connector (only for music playback)**
- 5 **AUX input connector**
- 6 **Optical input connector**
- 7 **AC input power connector**

---

## Position Your Sound Bar

You are recommended to place the Sound Bar on the top of the table and right below the center of your TV.

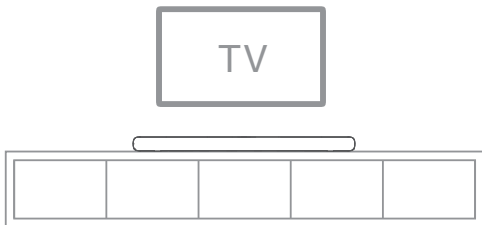

---

## Install/replace the remote control batteries

### Warnings

- *Danger of explosion if battery is incorrectly replaced.  
Replace only with the same or equivalent type.*

## Caution

- The battery contains perchlorate material, handle it with care. For more information, please refer to [www.dtsc.ca.gov/hazardouswaste/perchlorate](http://www.dtsc.ca.gov/hazardouswaste/perchlorate)

- 1 Open the battery compartment, remove the old batteries if necessary.
- 2 Place two new AAA batteries into the battery compartment with the correct polarity (+/-).
- 3 Close the battery compartment.

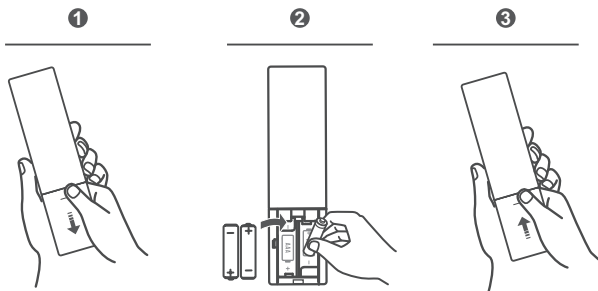

---



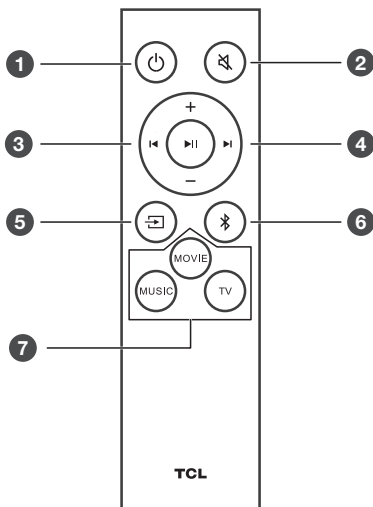



# Overview of the Remote Control



Press to power off.  
Press and hold to factory default.



Press to mute or unmute the sound.

- 3  Press to play/pause the music. (Under Bluetooth or USB mode)
-  Switch to previous music. (Under Bluetooth or USB mode)
-  Switch to next music. (Under Bluetooth or USB mode)
- 4  Decrease or increase the volume level.
- 5  Source input.
- 6  Press to switch the audio source to Bluetooth mode.  
Press and hold to enter pairing mode.
- 7 **MOVIE / MUSIC / TV**  
Press to select the equalizer (EQ) effect when you are watching **TV**, **movie** or listening to **music**.



## 3 Connect your Sound Bar system

After you have fixed the position of the Sound Bar, you can start connecting it to your TV or other devices and listen to the audio through your Sound Bar. Make sure you have muted the audio of your TV or device. For more information, check the user manual of your TV or device.

---

---

## Connect with the optical cable

- 1 Remove the protective caps from the optical cable (sold separately) when necessary.
- 2 Connect one end of the optical cable to the optical input connector on your Sound Bar and another end to the optical output connector of your TV or device.

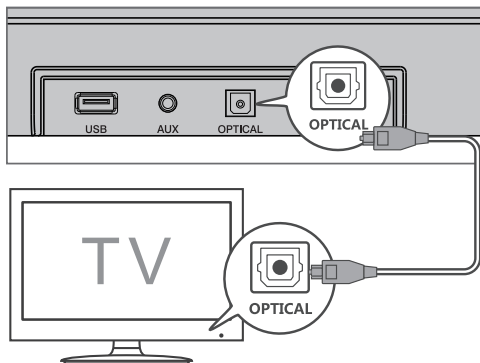

### Note

- If there is no sound output from the Sound Bar, try to activate the PCM signal output on your TV or device. PCM is used to convert analog audio signals into digital audio signals in most devices. For more information of how to activate the PCM signal output, check the user manual of your TV or device.

---

## Direction for setting up your Sound Bar using an optical cable



Do not bend or kink the optical cable (SPDIF) as it is fragile and can easily get damaged and broken.

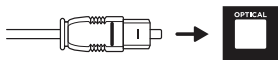

To get the best possible audio experience using the optical cable:

- 1 Press the Home button on your TCL TV Remote.
- 2 Navigate to **Audio** option under **Settings**.
- 3 Uncheck the "**TV speaker enabled**" option.
- 4 Under **S/PDIF** and **ARC**, select **PCM-Stereo**.

---

## Connect with the 3.5mm-to-3.5mm audio cable

You can either:

- connect one end of the 3.5mm-to-3.5mm audio cable (sold separately) to the AUX input connector on your Sound Bar and another end to the headphone or audio output connector on your TV or device. This will disable the sound of your TV built-in speakers; or
- connect one end of an RCA-to-3.5mm audio cable (sold separately) to the AUX input connector on your Sound Bar and other ends to the TV's audio output connectors.

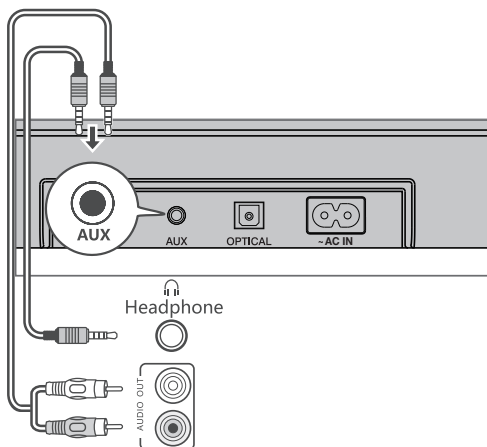



---

# Connect the Sound Bar with your Bluetooth device

## Notes

- Make sure your wireless device supports the Bluetooth function.
- The operational range between the Sound Bar and your Bluetooth device is approximately 10 meters (without any obstacle between the Bluetooth device and the Sound Bar).

- 1 Press  on the side of your Sound Bar or remote control to power on the Sound Bar.
- 2 Press and hold  on the remote control.
  - The blue LED flashes quickly. The Sound Bar is ready to pair.
- 3 Power on your Bluetooth device and activate its Bluetooth function.
- 4 Select **TCL 3100** on the pairing list of your Bluetooth device.
  - You hear distinct double beep sound.
  - The blue LED remains on solidly when pairing is successful.

## Tip

- If you cannot find the model name **TCL 3100** on your Bluetooth device, press and hold **▶||** on the remote control. You will see the blue LED flashes rapidly. Now the Sound Bar is entering the pairing mode.

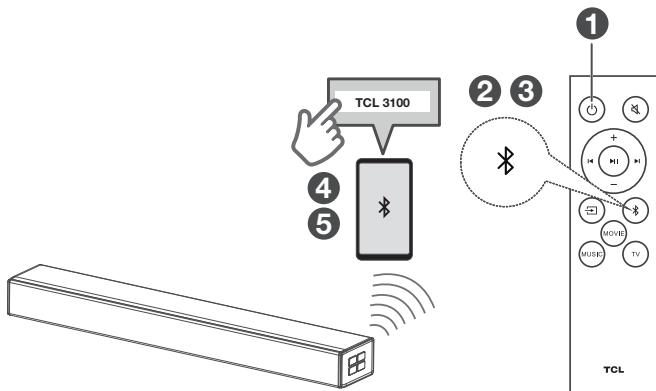





Your Sound Bar system is now set up and ready to be used.

- 5** To disconnect the Bluetooth function, you can:
- press **↔** on the Sound Bar or remote control to switch to another source; or
  - disable the Bluetooth function on your device; or
  - press and hold **▶||** on the remote control for 3 seconds.

---

## Use the USB cable or device for music playback

- 1 Connect the USB device to the USB Type A connector on your Sound Bar.
- 2 Press  on the Sound Bar or remote control. until the cyan LED is on.
- 3 You can now listen to music through the Sound Bar.
  - To pause or resume music, press  on the remote control.
  - To skip to the previous or next track, press  or  on the remote control.

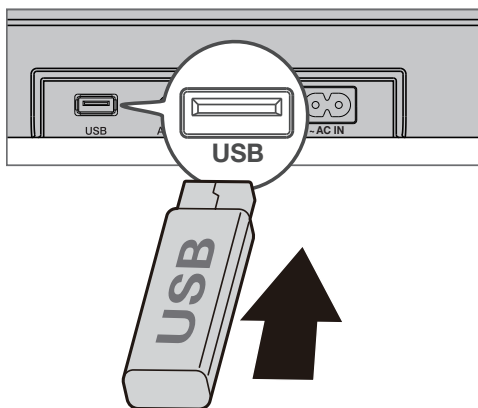

---

## Connect your Sound Bar to power supply

- 1 Make sure that you have completed all other connections before connecting the Sound Bar to power supply.
- 2 Make sure the power supply voltage complies with your country's safety standards (see 'Specifications' on page 22)
- 3 Connect one end of the supplied AC power cord to the AC input connector on your Sound Bar.
- 4 Connect one end of the supplied AC power cord to the AC input connector on your Sound Bar and another end to the power socket on the wall.

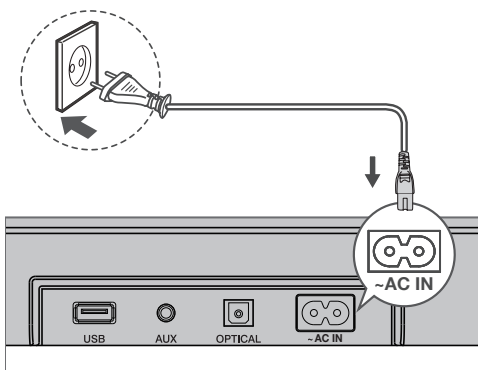



# 4 Use your Sound Bar system

---

## Use your Sound Bar with the side panel or remote control

- 1 Make sure the Sound Bar is properly connected to the power supply and sources.
- 2 Press  at the side panel of your Sound Bar or remote control to switch to the corresponding source.

### LED behaviors under different source modes

LED indicators	Source mode
Red	In standby mode
Green	in AUX mode
Blue	in Bluetooth mode
Yellow	in Optical mode
Cyan	in USB mode
Blue LED flashes quickly	waiting for Bluetooth pairing
Blue LED flashes slowly	search and connect the previous paired device

## **Note**

- After powering on your Sound Bar, if there is no operation performed on either the Sound Bar or remote control within 10 seconds, all LED indicators on the Sound Bar will turn off and light up again when the operation is resumed.

## **Tip**

- You can use more advanced functions on the remote control (see 'Overview of the remote control' on page 10).

# 5 Specifications

## Sound Bar

- Power adapter: AC~100-240V, 50/60Hz
- Power consumption: 15W
- Power consumption at standby mode:  $\leq 0.5W$
- Impedance:  $8\ \Omega$
- Frequency response: 60 Hz-20 kHz
- Dimensions (WxHxD): 700 x 125 x 155(mm)
- Weight: 3.7 lbs (1.7 kg)
- Operating temperature:  $0^{\circ}C - 45^{\circ}C$

## Bluetooth

- Bluetooth version: 4.2, Bluetooth profile - Bluetooth stereo supported (Advanced Audio Distribution Profile - A2DP; Audio Video Remote Control Profile - AVRCP)
- Frequency range: 2402 Mhz – 2480 Mhz
- Max transmitting power:  $\leq 5dBm$

## Remote control

- Distance/Angle: 6m/  $30^{\circ}$
- Battery type: 1.5V AAA battery x 2, user replaceable.

# 6 Notice

---

## Declaration of conformity

Hereby, TCL Entertainment Solutions Limited declares that this product is in compliance with the essential requirements and other relevant provisions of Directive 2014/53/EU. You can find the Declaration of Conformity on [www.tcl.com](http://www.tcl.com).

The EU declaration of conformity can be downloaded directly at [www.tcl.com](http://www.tcl.com) in corresponding product download page in local region.

---

## Disposal of your old product and battery



Your product is designed and manufactured with high quality materials and components, which can be recycled and reused.



This symbol on a product means that the product is covered by European Directive 2012/19/EU.



This symbol means that the product contains a battery covered by European Directive 2013/56/EU which cannot be disposed of with normal household waste. Inform yourself about the local separate collection system for electrical and electronic products and batteries. Follow local rules and never dispose of the product and batteries with normal household waste. Correct disposal of old products and batteries helps prevent negative consequences for the environment and human health.

### **Remove the disposable battery**

To remove the disposable batteries, see the section 'Install/replace the remote control batteries' on page 8.

### **Environmental protection and sustainability**

We have omitted all unnecessary packaging and make sure it is eco-friendly and sustainable.

---

## Trademarks

---



The Bluetooth® word mark and logos are registered trademarks owned by Bluetooth SIG, Inc. and any use of such marks by TTE Corporation is under license. Other trademarks and trade names are those of their respective owners.

---



Manufactured under license from Dolby Laboratories. Dolby, Dolby Audio, and the double-D symbol are trademarks of Dolby Laboratories Licensing Corporation.

# 7 FAQ

## **No power**

- Make sure the AC power cord and AC input connector are connected properly.
- Make sure there is power supply.
- Make sure the Sound Bar has turned on.

## **No sound**

- Make sure the audio cable is connected to the Sound Bar and your device.
- Make sure you have selected the correct source.
- Press **+** to increase the volume level.
- Make sure the Sound Bar is not muted.

## **The remote control does not work.**

- Make sure you have selected the correct source.
- Make sure the distance of remote control and the Sound Bar is within operational range.
- Make sure the battery is correctly inserted and is working.
- Make sure the remote control is close to the remote control sensor of the Sound Bar.

## **I hear distorted sound.**

- Make sure all cables are properly connected.
- Make sure you have selected the correct source.
- Make sure the TV is muted if you play audio from the TV.

## **I cannot find the Bluetooth name of this Sound Bar on my Bluetooth device.**

- Make sure the Bluetooth function is activated on your Bluetooth device.
- Make sure the Sound Bar has paired with your Bluetooth device.

**TCL support:**

Please visit [www.tcl.com](http://www.tcl.com)

---

**WE ARE  
READY TO  
HELP** contact us first  
with any questions



**TAKE CARE WHEN  
REMOVING THE SOUND BAR**